

A. Applicant details

Legal status of applicant (tick)

Individual (Go to ①) *Family Property*

Registered company (Go to ②) Trust (Go to ②)

Incorporated society (Go to ②) Other (Go to ②)

① Applicant name (individual) *Julian Russell Odeberg Angela Jane Thompson + Victoria Trust*
Darryn Russell Odeberg



Postal address (if different from above)

Postcode

② Applicant name (full name of registered company, trustees, educational institute or incorporated society)

Trading name or trust name (if different from applicant name)

NZBN if applicable (To apply go to: <https://www.nzbn.govt.nz>)

Company, trust or incorporated society registration number

Registered office of company or incorporated society (if applicable)

Company phone

Company website

Contact person and role

Phone

Mobile phone

Email

Postal address

Postcode

Street address (if different from Postal address)

Postcode

B. Variation of an existing licence and/or concession.

Is this application *varying* an existing licence/lease concession?

No

Yes

Licence/lease concession number(s) you wish to vary

C. Pre-application meeting

Have you had a pre-application meeting or spoken to someone in DOC?

No (continue to section D.)

Yes (record details below)

Date of DOC pre-application meeting 14/4/26

Name of DOC staff member(s) Trish Gill

Name of person(s) who had the pre-application meeting with DOC Julian Odeyng + Trish

Record relevant notes/comments:

Let me know, as I was unaware that D.O.C was unable to contact me about expired consent and I had to re-apply (very helpful.)

D. What structures or activities are currently on SFR fronting your property?

All existing/new structures or activities are required to have prior approval for the continued occupancy of SFR. This may mean you have unauthorised structures or activities adjacent to your property that you are unaware of.

Please select below all appropriate structures and activities in relation to SFR fronting your property (Licensed and/or Unlicensed):

- | | | |
|--------------------------------|----------------------|--------------------|
| Boardwalk | <u>Boatshed</u> | Box steps |
| <u>Bridge</u> | Concrete path | Concrete steps |
| Conveying electricity | Conveying gas | Conveying telecoms |
| Conveying water | Culvert | Decking |
| Drainage/Stormwater pipe | Handrail | House |
| <u>Retaining wall <1.5m</u> | Retaining wall >1.5m | <u>Seawall</u> |
| Septic system | Shed | Shelter |
| <u>Slipway</u> | Staircase | Step risers |
| Tramway/Trolley | Water tank | Other: _____ |

Note: If the activity is not in this list check the activity on the DOC website to find the correct application form or book a pre-application meeting. Application forms that combine applicant and activity information on the DOC website include:

- [Aircraft activities](#)¹⁰
- [Easements](#)¹¹
- [Land based guiding](#)¹²

Provide details of currently held SFR Licenses, Permissions/Permits and Easements:

E. Duration

State how long (months and years) you want any granted concession for private buildings or structures and why.

Note: *An application for a concession for a period over 10 years must be publicly notified, an application for a concession up to 10 years will not be publicly notified unless the adverse effects of the activity are such that it is required, or if an exclusive interest in the land is required.*

Since this application will be notified
I seek a 30 year term.

F. Is this application for existing or new buildings and structures?

Select from the following:

- No (for **new buildings and structures only** fill in all sections **except** Section G.)
- Yes (for **existing buildings and structures only** fill in all sections **except** Section H.)
- Both (for **existing AND new buildings and structures** complete **both** Sections G. & H.)

¹⁰ <https://www.doc.govt.nz/get-involved/apply-for-permits/business-or-activity/aircraft-activities/>

¹¹ <https://www.doc.govt.nz/get-involved/apply-for-permits/business-or-activity/access-easements/>

¹² <https://www.doc.govt.nz/get-involved/apply-for-permits/business-or-activity/land-based-guided-activities/>

G. Existing Buildings or Structures – Description of Encroachment on Sounds Foreshore Reserve

1. Provide the Lot, Deposited Plan (DP) number and name of the bay of the adjoining property to the encroachment.

Lot number: FR 582 Lots 15 16 DP 1152 IV Linkwater

DP number: DP 1152 BLK IV Linkwater

Name of the bay: Torea Moua Bay

Address (if applicable): At The toe of Torea Bay.

2. Describe in detail the existing encroachment, including when it was installed / constructed, the size and footprint of the structure/s and the purpose of the structure/s. Attach all relevant information and list in section L Attachments including:

- Record(s) of Title for your property (mandatory)
- Maps
- NZTM coordinates
- Photographs
- Survey plans
- Resource consent applications
- Concept plans
- Engineering reports
- Other

3. Could this structure/work be reasonably located on your private property? Provide details of other sites considered:

The existing Boatshed & Slipway
Needs to be at the waters edge

4. Is the building going to be used for commercial purposes? Give details/reasons.

No it is for the Storage of Boats
and Batch equipment, family personal
use only.

H. New Structures/Work - Description of Encroachment on Sounds Foreshore Reserve

1. Provide the Lot, Deposited Plan (DP) number and name of the bay of the adjoining property to the encroachment.

Lot number:

DP number:

Name of the bay:

Address (if applicable):

Handwritten scribbles consisting of two parallel diagonal lines.

2. Describe in detail the proposed encroachment including when work is to commence, the size and footprint of the structure/s and the purpose of the structure/s. Attach relevant documents, including:

- Record(s) of Title (mandatory)
- Maps
- NZTM coordinates
- Photographs
- Survey plans
- Resource consent applications
- Concept plans
- Engineering reports
- Other

Handwritten scribbles consisting of two parallel diagonal lines.

3. Could this structure/work be reasonably located on your private property? Provide details of other sites considered:

NO

4. Is the activity applied for being used for commercial purposes? Give details/reasons.

Permissions @ DOC.govt.nz

I. Are you applying for anything else?

Are you applying for other DOC permissions (e.g. easement, concession) as well as this activity?

No	<input checked="" type="checkbox"/>
Yes	<input type="checkbox"/>

If yes, state the other permissions you are applying for?



J. Planning provisions (all applicants)

1. Does your proposal comply with the Marlborough District Council district plan(s) for the area?

No

Yes

2. Do you require resource consent and/or building consent? (Ask the relevant councils' planning sections for advice. Generally, if structures are to be built (or have been built), it is likely that consent/s will be required).

No

Yes

3. If resource/building consent is required, provide details of the consent together with information on progress with the application for consents. (It will be a condition of any licence to occupy that all necessary consents have been obtained.)

The Boat Shed was existing when the property was purchased approx 34 years ago. We have no R.C or Building consent papers for the construction.

K. Consultation undertaken

DOC has a statutory obligation to give effect to the principles of the Treaty of Waitangi. This often requires consultation with our Treaty Partner (iwi/hapū/whānau of local Māori) on your application. If you have already consulted with our Treaty Partner, or with other interested stakeholders, DOC would like to know about it.

We recommend you discuss consultation with a DOC staff member before starting your application.

Have you carried out any consultation?

No

Yes

If yes, supply details for each group consulted with:

Whānau/hapū/iwi or other interested party consulted with:

Name of individual you consulted with:

Date of consultation:

Form of consultation (e.g. email, meeting):

Outcome of consultation*:

***If you received a written response to your consultation attach a copy to this application. Record the document details in the L Attachments section of this form.**

L. Consistency with DOC statutory plans

List [DOC's statutory planning documents](#)¹³ relevant to your application (e.g. Nelson/Marlborough Conservation Management Strategy):

Conservation General Policy Nelson
Marlborough Conservation Management
Strategy, and Marlborough Sounds
Maritime Park Management Plan.

Are you aware of any potential inconsistency your activity may have with DOC's statutory planning documents?

No	<input type="checkbox"/>
Yes	<input checked="" type="checkbox"/>

1 Phoenix Palm.

If you have answered 'yes' explain why it is inconsistent with the statutory planning documents.

We have 1 single 6 meter high Phoenix Palm that sits by the boat shed on a grassy knoll. The fronds are managed by removing and Burning from spring till late Autumn each year when requested by many people. Because of its location it does not compete with other vegetation. Contrary to popular belief we have never seen rodents in or around that tree. It has cultural significance to our family as my father in law loved to sit under it and we sprinkled his ashes around it 8 years ago. It provides excellent shade to sit under and nobody has been hurt by fronds falling as that hazard is well managed. Although it is considered a pest plant of North there is only one on this site or as far as the eye can see. There is limited access to this place (Boatonly

¹³ <https://www.doc.govt.nz/about-us/our-policies-and-plans/statutory-plans/>

So Risk to anyone is less than minor.

finally our family wishes it to stay for reasons given posing little to no harm to anyone and being special to us. Thank you

Published: November 2022

Julian Odeberg,

M. Description of actual and potential effects of existing or proposed works (all applicants)

Identify actual or possible effects of the activity applied for. Describe the actions you propose to take to avoid, remedy or mitigate those effects. For further information check [DOC's Environmental Impact Assessment¹⁴](https://www.doc.govt.nz/get-involved/apply-for-permits/managing-your-concession/environmental-impact-assessment/#low-medium-impact) and [DOC's guide to preparing your environmental impact assessment¹⁵](https://www.doc.govt.nz/globalassets/documents/about-doc/concessions-and-permits/concessions/guide-to-environmental-impact-assessments.pdf).

In many cases an Assessment of Environmental Effect (AEE) prepared for resource consent under the Resource Management Act 1991 will satisfy this requirement.

Provide details below and record the document details in the L Attachments section of this form.

Effects	Description
Effects on the landscape e.g. ability of landscape to accommodate changes.	The structure is in site. It is painted dark green to keep with the environment surrounding foreshore and bus
Effects on the visual composition of the landscape.	The shed is set back and surrounded in native bush blending as much as possible with plantings
Effects on cultural values of Tangata Whenua or members of the public.	Not consulted with as the structure was in place when purchased it in 1992 My son n Law's Tribe is Ngirahū
Effects on historic sites or objects including Wāhi Tapu e.g., disturbance of the ground.	This site is Boat access only. No disturbance of ground or bush is expected.
Effects on existing infrastructure such as roads, tracks, huts, carparks etc.	Boat access only. There is no tramping tracks carparks Roads. only a family Boat + Shed.
Effects on existing vegetation e.g. disturbance or removal of vegetation.	Already Existing. Structure.

¹⁴ <https://www.doc.govt.nz/get-involved/apply-for-permits/managing-your-concession/environmental-impact-assessment/#low-medium-impact>

¹⁵ <https://www.doc.govt.nz/globalassets/documents/about-doc/concessions-and-permits/concessions/guide-to-environmental-impact-assessments.pdf>

Effects of **earthworks** e.g. removal of topsoil and where removed earthworks will be stored. Note: All earthworks storage on public conservation land needs to be authorised.

Nil

Effects on **wildlife or wildlife habitat**.

Nil.

Effects on **aquatic habitat** (waterways, swamps, freshwater animals and vegetation).

Nil

Effects on **other users** (Tangata Whenua, recreational users, and concessionaires) of the land.

All people are free to use the foreshore. and Do.

Effects of potential **increased threats** (pests, weeds, pathogens, and fire) to public conservation land.

Nil.

Effects of **increased rubbish, toilet waste or debris left on public conservation land** during construction and regular use of the easement.

None.

Cumulative effects that could be caused by the activity.

None.

Positive effects of the activity.

None Really.

N. Attachments

Attachments should *only* be used if:

- You are answering a specific question and providing a report e.g. Environmental Impact Assessment.
- There is not enough space on the form to finish your answer.
- You have additional information that supports your answer.
- You wish to make an additional request of DOC regarding the application.

Label each document clearly and complete the table below.

Section of the application form the attachment relates to	Document title	Document format (e.g. Word, PDF, Excel, jpg etc.)	Description of attachment
<u>Correct example ✓</u> D	Existing structure relevant information	PDF	Certificate of title, maps, photographs, resource consent application, engineering report.
<u>Correct example ✓</u> E	Environmental Impact Assessment	Word	List of additional potential effects (e.g. due to unusual activity) and proposed methods to avoid, remedy or mitigate the effect.
<u>Incorrect example X</u> <u>Table</u>	Doc1	Word	Table
	Resource consent	UO 70778	coastal Permit x3 Jetty Slipway Removal + Replacement
	Resource consent	UO 60220	Raft mooring for a vessel up to 6.0 metres

O. Checklist

Application checklist

Tick

I have completed all sections of this form relevant to my application and understand that the form will be returned to me if it is incomplete



I certify that the information provided in this application form and any attached additional forms is, to the best of my knowledge true and correct



I have attached all relevant information (e.g. Certificate of Title, maps, photographs, resource consent applications etc) and recorded them in **Section N**.



I have appropriately labelled all attachments and completed the **Section N. Attachments** to match



I have completed the terms and conditions for a credit account with the Department of Conservation outlined in **Section P**.



I will email permissions@doc.govt.nz my:



- Completed applicant information form
- Any other attachments

P. Terms and conditions for a credit account with the Department of Conservation

Have you held an account with the Department of Conservation before?	Tick
No	<input type="checkbox"/>
Yes	<input checked="" type="checkbox"/>
If 'yes' under what name:	DR and JR Odering. AJ Thompson under Victoria Trust

In ticking this checklist and placing your name below you are acknowledging that you have read and agreed to these terms and conditions for an account with the Department of Conservation.

Terms and Conditions	Tick
I/We agree that the Department of Conservation can provide my details to the Department's Credit Checking Agency to enable it to conduct a full credit check.	<input checked="" type="checkbox"/>
I/We agree that any change which affects the trading address, legal entity, structure of management or control of the applicant's company (as detailed in this application) will be notified in writing to the Department of Conservation within 7 days of that change becoming effective.	<input checked="" type="checkbox"/>
I/We agree to notify the Department of Conservation of any disputed charges within 14 days of the date of the invoice.	<input checked="" type="checkbox"/>
I/We agree to fully pay the Department of Conservation for any invoice received on or before the due date.	<input checked="" type="checkbox"/>
I/We agree to pay all costs incurred (including interest, legal costs and debt recovery fees) to recover any money owing on this account.	<input checked="" type="checkbox"/>
I/We agree that the credit account provided by the Department of Conservation may be withdrawn by the Department of Conservation, if any terms and conditions (as above) of the credit account are not met.	<input checked="" type="checkbox"/>
I/We agree that the Department of Conservation can provide my details to the Department's Debt Collection Agency in the event of non-payment of payable fees.	<input checked="" type="checkbox"/>

Applicant name/s (of authorised person/s):	Julian Russell Odering	Date:	23/6/26.
--	---------------------------	-------	----------

For Departmental use	
Credit check completed	
Comments:	
Signed	Name
Approved (Tier 4 manager or above)	Name



**RECORD OF TITLE
UNDER LAND TRANSFER ACT 2017
FREEHOLD
Search Copy**



R. W. Muir
Registrar-General
of Land

Identifier MB40/10 Land Registration

District Marlborough **Date Issued** 16

January 1941

Prior References

MB38/62

Estate Fee Simple
Area 3.4047 hectares more or less
Legal Description Lot 15-16 Deposited Plan 1152

Registered Owners

Darryn Russell Odering as to a 1/3 share

Julian Russell Odering as to a 1/3 share

Angela Jane Thompson, Mark Lawrence Thompson and Victoria Trustee (Thompson) Limited as to a 1/3 share

Interests

349 Order in Council exempting the road shown hereon from the provisions of Section 128 of the Public Works Act 1928
15.1.1929 at 3.00 pm

TO Andrew Winchcombe
a.winchcombe@doc.govt.nz
17/6/26.

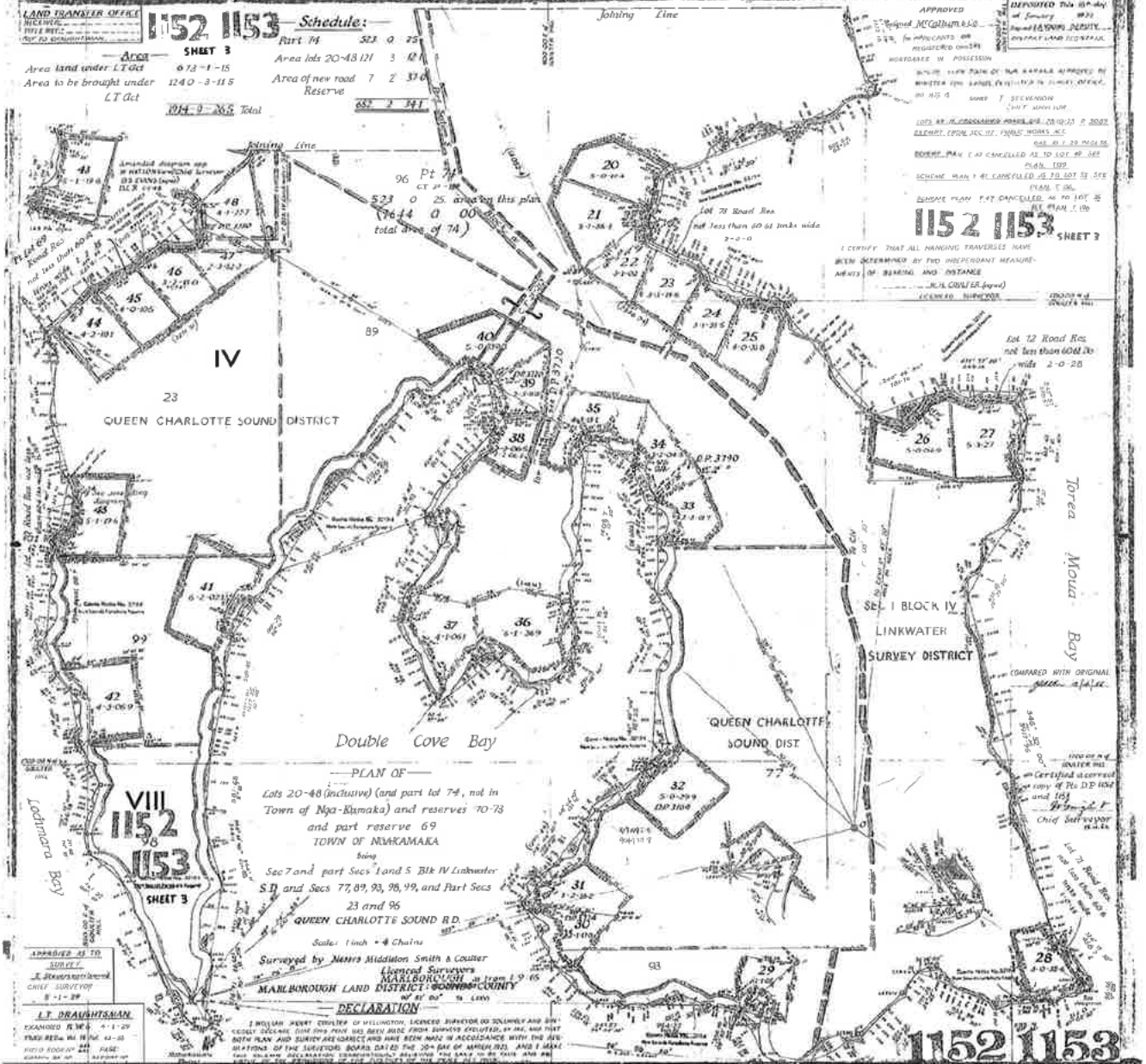



Torea Bay
U060220



Scale 1:2529

Mooring Terms & Conditions
Matters District Council
Matters this information available, subject to it being used professionally
for the purposes for which it was intended.
-Staff have no liability for any claim regarding the operational use
of the data or damages, including but not limited to
indirect, special, incidental or consequential damages
-Do not guarantee that the data is free of errors or defects