



HERITAGE  
EXPEDITIONS

AUTHENTIC SMALL SHIP  
EXPEDITION  
CRUISING

2025-2026



# Our Story

Heritage Expeditions are Australasia's only family-owned and -operated expedition cruise company. Founded by dedicated conservationists Rodney and Shirley Russ in 1984, our unique itineraries are honed by more than 40 years of unparalleled experience. Heritage Expeditions is now run by Rodney and Shirley's sons Aaron and Nathan, who grew up in the family business, from our head office in Christchurch, New Zealand.

A family of botanists, biologists and adventurers, the Russ family are driven by their passion for, and knowledge of, sharing the world's wildest and most isolated places. All voyages are carefully planned to minimise the impact on the environment, wildlife and their habitats, oceans and waterways, and the remote tribes and villages we visit. We operate two purpose-built expedition vessels – our 18-guest expedition yacht *Heritage Explorer* and 140-guest flagship *Heritage*

*Adventurer*, and our itineraries are made possible by our longstanding relationships with government agencies, conservation programmes and remote communities. Not only do our intrepid guests tick off bucket list adventures when travelling with us, they also make meaningful contributions to science, conservation and support the remote villages we visit. Guests return home as ambassadors for these special places, wilderness, wildlife and cultures, and help ensure their ongoing protection sharing their adventures with friends and family.

Heritage Expeditions also takes action: we support and contribute to the conservation of the places we visit, we 'buy local' and employ locally, empower our guests with knowledge of local customs and traditions, and responsibly dispose of waste. When you explore with Heritage Expeditions, we cruise lightly wherever we are in the world.



Images: Cover: Steve Bradley. This spread: Samuel Blanc

# Expedition Cruising

Heritage Expeditions are proud pioneers of responsible, conservation-driven small ship expedition cruises to some of the most wild, least-explored and biologically rich regions on the planet. These include the islands and shores of Japan, Taiwan, Philippines, Indonesia, Papua New Guinea, Solomon Islands, Vanuatu, Australia's Kimberley Coast, around New Zealand and down to the world's most remote Subantarctic Islands and into the 'heart of Antarctica' the Ross Sea where we are the world's most experienced operators with more than 35-years experience.

Our authentic expedition vessels are designed to navigate areas inaccessible to larger ships and avoid the negative impact of large cruise vessels and groups on a culture or ecosystem. Our voyages are designed to engage guests with a wide range of interests, with expedition days starting early in order to observe wildlife activity and make the most of the morning light for photography. Guests explore by Zodiac safari, on foot, kayak and local transport well off the beaten path, engage in citizen science projects and actively support conservation efforts as we follow in the footsteps of some of history's most famous explorers.

Discover new frontiers alongside our world-renowned team of naturalists, botanists, geologists, historians and experts sharing the natural and human history we experience as your voyage unfolds.



Image: Jessa Thurman



# Heritage Adventurer

Purpose-built for adventure, our luxurious 140-guest flagship *Heritage Adventurer* is a true pioneering expedition vessel of exceptional pedigree. Often referred to as the 'Grande Dame of Expedition Cruising' due to her celebrated history and refined sophistication, she combines the highest passenger ship ice-class rating with 14 Zodiacs ensuring every guest is able to maximise their expedition adventure. Enjoy inclusive travel with all-inclusive dining, house wine and beer with lunch and dinner, all standard excursions, pre and post cruise transfers and lecture series by our noted expedition guides and special guests.



Images: Top Left: Aaron Russ. Below, from left: Even Bell, Fiona Wardle, Dana Brown, Fiona Wardle

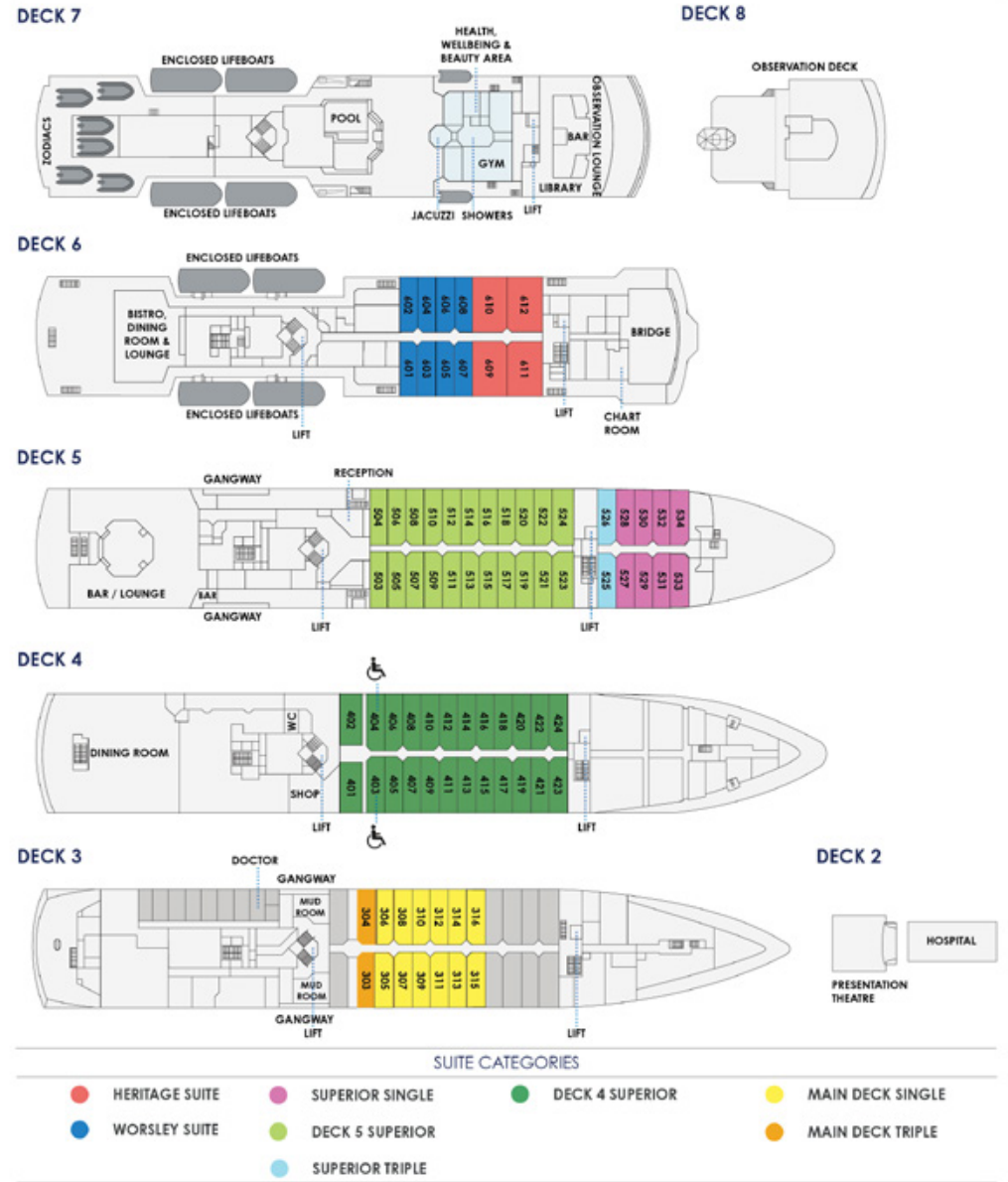

# Japan & Asia

Where culture, wildlife, wilderness & history abound



Images: Left: Ewen Bell. Right, from top: Ewen Bell (x3), Fiona Wardle



## Discover the Islands of Japan

12 Days | From \$15,995 | Apr & May 2025/26

Combining a thrilling mix of culture, history and the natural world this voyage sees you exploring ancient castles, serenely beautiful gardens and opulent temples and shrines alongside some of Japan's stunning natural landscapes sailing between Tokyo and Osaka, including Ulsan, South Korea.



## Eternally Sacred Japan & South Korea

11 Days | From \$14,695 | May & Jun 2025/26

Discover Japan's seamless blend of ancient customs, and ultramodern living, culinary creativity, arts and gardens as we explore iconic cities and seldom visited remote coastlines between Tokyo and Osaka including Ulsan, South Korea on this unforgettable voyage of discovery.



## Japan's National Parks, Art & Culture

16 Days | From \$21,395 | May & Jun 2025/26

Set sail on a rare circumnavigation of Japan's main island and explore its unspoiled wilderness, arts, culture and rich history including both Japan's smallest and one of its largest national parks, Great Gardens, iconic art island Naoshima, Hiroshima and South Korea's 'museum without walls'.



## Asian Island Odyssey

19 Days | From \$25,395 | Jun 2025/26

Cruise through your bucket list on this ultimate island-hopping expedition crossing both the Tropic of Cancer and the Equator. Discover rarely-visited islands as we swim with Whale Sharks, explore colourful coral reefs, white sand beaches and primeval wildlife-filled jungles and more.



# South Pacific

Unforgettable cultural & wildlife encounters in paradise



Images: Left: Steve Bradley. Right, from top: Fiona Wardle, Steve Bradley (x2), Cathy Finch



## Indonesian Explorer

18 Days | From \$22,975 | Sep & Oct 2025/26

Discover paradise on an expedition through Indonesia: Swim with Whale Sharks, walk with Komodo Dragons, snorkel world famous Pink Beach, discover Jacques Cousteau's "underwater nirvana" Wakatobi National Park and explore the turquoise waters and rainbow corals of Raja Ampat and more.



## Discover the Secrets of Melanesia

17 Days | From \$21,500 | Oct & Nov 2025/26

Experience the Sepik River Dragon Dance, the 'island of volcanoes' home to the sacred Rom dance, explore wildlife-filled pristine jungles, discover WWII wrecks and relics, snorkel some of the world's best reefs, visit remote tribes and villages, and swim and sip bubbles at iconic Champagne Beach and more.

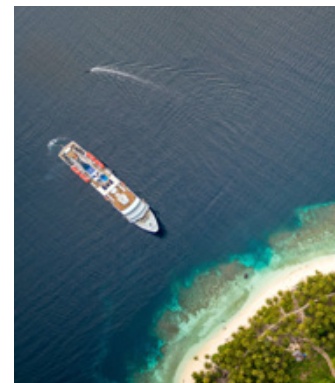

## Grand Pacific Odyssey

25 Days | From \$21,395 | Mar 2025

Set sail on a true adventure as we explore reef-fringed tropical islands, visit historic sites and experience forgotten cultures and incredible wildlife encounters cruising from New Zealand to Japan and through the South Pacific on the incomparable 25-day Grand Pacific Odyssey.

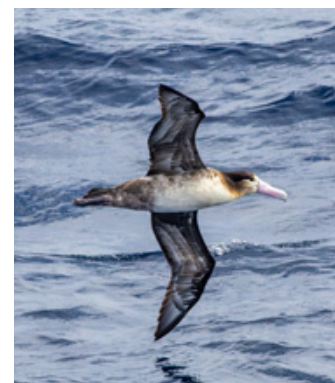

## Western Pacific Odyssey

25 Days | From \$21,395 | Mar 2025

Known in birding circles simply as the 'WPO', this expedition from New Zealand to Japan, via Norfolk Island, New Caledonia and Melanesia, incorporates many of the key birding areas in the South West Pacific. Join us on what is widely considered one of the world's 'must do' birding voyages.



# Australia & New Zealand

Experience grand scale scenery & down under adventures



Images: Left: Steve Bradley. Right, from top: Julia Mishina, Doug Gimesy (x2), Tom Schandy



## Kimberley Explorer

11 Days | From \$13,650 | Jun & Aug 2025/26

Discover an ancient landscape like no other as we expedition cruise the untouched beauty of Australia's iconic Kimberley coast. Experience the truly epic scale of this magnificent region, discover indigenous rock art and connections to land, historic sites and incredible wildlife encounters.



## New Zealand Coastal Odyssey

14 Days | From \$15,290 | Feb & Mar 2025/26

Specially designed by Kiwis to showcase New Zealand's hidden gems and iconic destinations, discover the bright lights of its largest city, geothermal wonderland, avant garde fashion capital, world famous fiords and sounds, the adventure playground of Queenstown and more.

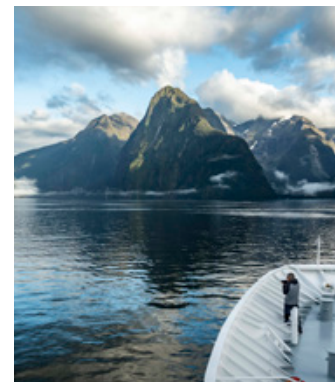

## Unseen Fiordland & Stewart Island

6 Days | From \$6,500 | Jan & Dec 2025/26

Experience the time-forgot rawness of wildlife-rich Stewart Island and primordial majesty of Fiordland, where clouds scud the ragged peaks of glacier-cleaved mountains streaked with waterfalls, only accessible by expedition ship. A rare opportunity to combine two iconic destinations on one voyage.



## Beyond Fiordland

12 Days | From \$16,250 | Dec & Jan 2025/26

This voyage combines remarkable wildlife encounters and observations as we explore remote parts of New Zealand's Southern region, an area known for its range of wildlife and jaw dropping scenery on a grand scale. Includes New Zealand's Subantarctic Islands, Fiordland and Stewart Island.



# Subantarctic Islands

Explore world-class wildlife havens



Images: Left: Gunther Riehl. Right, from top: Cathy Finch, Richard Pendavingh, Andy Woods, Tessa Bickford



## Birding Down Under

17 Days | From \$27,150 | Dec 2025/26

The ultimate Subantarctic adventure, explore the world's most remote Subantarctic Islands including Snares, Bounty, Antipodes, Auckland, Campbell, Macquarie and Chathams. Home to the world's most diverse collection of seabirds this voyage combines birds, history, wildlife and adventure.



## Galapagos of the Southern Ocean

12 Days | From \$18,500 | Nov & Dec 2025/26

Named after its diversity of wildlife, this voyage explores the spectacular wildlife havens of Australia's Macquarie Island and New Zealand's Subantarctic Islands, home to raucous penguin colonies, sunbathing seals and elephant seals, duelling sea lions, gamming albatross and more.



## Beyond Fiordland

12 Days | From \$16,250 | Dec & Jan 2025/26

This voyage combines remarkable wildlife encounters and observations as we explore remote parts of New Zealand's Southern region, an area known for its range of wildlife and jaw dropping scenery on a grand scale. Includes New Zealand's Subantarctic Islands, Fiordland and Stewart Island.



## Forgotten Islands of the South Pacific

8 Days | From \$9,995 | Dec 2025/26

The ultimate New Zealand wilderness expedition; discover soaring, nesting and gamming albatross, Snares Crested Penguin, Campbell Island's Flightless Teal and Snipe, and explore flowering fields of megaherbs and iconic landscapes while observing New Zealand Sea Lions and Fur Seal colonies.



# Ross Sea, Antarctica

The bucket list voyage into the 'heart of Antarctica'



Images: Left: Meghan Maloney. Right, from top: Meghan Maloney, Cathy Finch, Fiona Wardle



## In the Wake of Scott & Shackleton

28 Days | From \$53,500 | Jan & Feb 2025/26/27

Sail south from New Zealand into the 'heart of Antarctica' the Ross Sea, via the Subantarctic Islands, on an epic voyage steeped in history. Expeditions to Antarctica from New Zealand take you further south into the frozen continent than any sea route.

Join our team of expert biologists, geologists and historians on a true bucket list expedition as we Zodiac cruise colossal ice shelves and icebergs, visit research stations, observe whales and seals, walk on the ice with Emperor Penguins and step inside the preserved historic huts of Shackleton, Borchgrevink and Scott as we follow in the footsteps of Antarctica's legendary explorers.

There are 4 historic huts and many other historic sites that bring this period of Antarctic history alive in a way that the many journals, books and films fail to convey. To visit Borchgrevink's Hut at Cape Adare, Shackleton's Hut at Cape Royds, Scott's Huts at Cape Evans and Hut Point are once-in-a-lifetime, truly personal experiences.

With shipping restricted by impenetrable pack ice to just two brief months each austral summer, very few non-scientific personnel will ever have the opportunity to visit this otherworldly beautiful territory. Every year more people will climb Mount Everest than venture into the 'heart of Antarctica'.

Heritage Expeditions offers such a voyage - In the Wake of Scott & Shackleton, on its own fully-equipped and ice-strengthened flagship *Heritage Adventurer*, crewed by some of the most experienced officers and sailors in the world, and staffed by a passionate and knowledgeable expedition team.



# Heritage Explorer

Setting the benchmark for New Zealand discovery travel, our luxurious 18-guest expedition yacht *Heritage Explorer* combines the ultimate in comfort with unique itineraries and a personalised experience. A contemporary wood-finished interior joins 10 well-appointed cabins across three decks, a dining room boasting spectacular 180-degree panoramas, lounge and bar featuring a flight of inclusive regional wines and beers and multiple viewing decks. Kayaks and fishing equipment are available for use during your voyage, while two tenders allow for deeper exploration and the unforgettable wildlife encounters synonymous with all Heritage Expeditions adventures.



Images: Top Left: Lindsay Thorpe. Below, from left: Aaron Russ (x2), Andy Woods, Aaron Russ

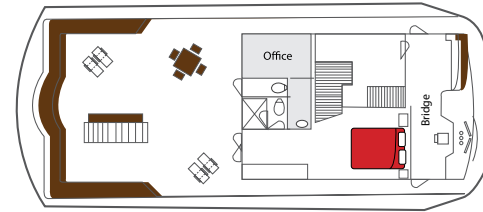
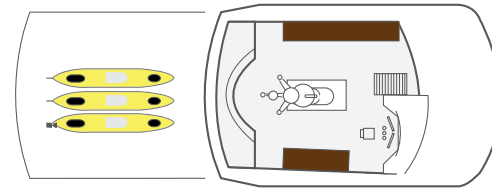

**Bridge Deck**

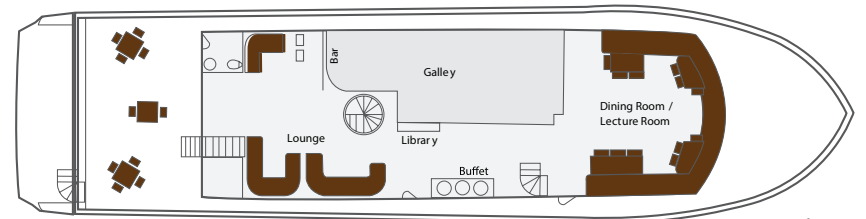

**Main Deck**

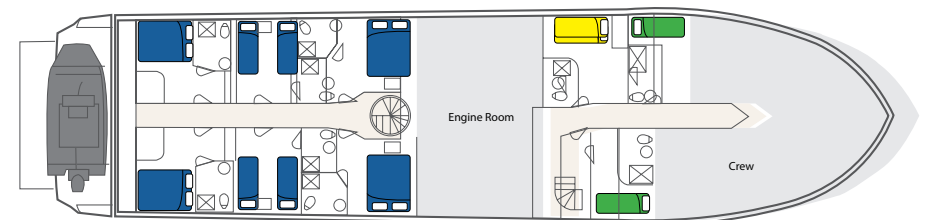

**Lower Deck**

- **Royal**
- **Wandering**
- **Salvin's**
- **Buller's**



# South Island Icons

Expedition Cruising Marlborough Sounds & Stewart Island



Images: Left- Andy Woods. Right, from top: Heritage Expeditions (x2), Tamzin Henderson, Fiona Wardle



## Discover Marlborough Sounds

7 Days | From \$5,645 | May, Nov & Dec 2025/26

Famed for the breath-taking beauty of its winding cobalt waterways, iconic landscapes, lush native forests, wildlife and remote coastlines, Marlborough Sounds is also rich in early New Zealand history and the location of some of the country's most important conservation efforts.



## The Top of the South

9 Days | From \$7,260 | Apr & Nov 2025/26

Explore the coves, beaches, waterways, wildlife and rich history of the top of New Zealand's South Island on this unforgettable expedition cruise of Queen Charlotte and Pelorus Sounds, French Pass, d'Urville Island and Abel Tasman National Park – home to Fur Seals and Little Blue Penguins.



## Unseen Queen Charlotte Sound

5 Days | From \$3,995 | May, Nov & Dec 2025/26

Hiking focussed, this voyage has been specially designed for more active travellers looking to explore these remote waterways, coves and coastlines only accessible by sea. This voyage gives walking and hiking enthusiasts the opportunity to trek sections of the iconic Queen Charlotte Walkway.



## Unseen Stewart Island

8 Days | From \$6,895 | Jan, Oct & Dec 2024/25/26

Discover Stewart Island's quirky town Oban, predator-free sanctuary Ulva Island, historic Paterson Inlet and Kaipipi Bay, the remote undisturbed beauty of Port Adventure, Port Pegasus, New Zealand's Amazon – Lords River, enjoy a drink with the locals at the iconic South Sea Hotel and more.



# Fiordland

Explore New Zealand's world famous fiords



Images: Left: Glenda Darling. Right, from top: Heritage Expeditions, Tamzin Henderson, Heritage Expeditions, Fiona Wardle



## All of the Fiords

10 Days | From \$8,195 | Feb, Mar & Jul-Sep 2025/26

Join the ultimate exploration of New Zealand's remote ice-carved mountains, verdant forests and winding fiords of Fiordland as we explore this treasured natural wonderland, its wildlife, conservation and history sailing between Preservation Inlet and Milford Sound.



## Southern Fiords Discovery

7 Days | From \$6,375 | Jan-Mar & Jul-Sep 2025/26

Explore the grand scale scenery, wilderness, forests, sounds and wildlife of Fiordland's Preservation and Chalky Inlets, and Doubtful and Dusky Sounds. Rich in natural history and geology, they are also the location of significant historical firsts and important conservation projects.



## Undiscovered Dusky Sound

5 Days | From \$4,850 | Jan-Mar & Jul 2025/26

Experience an unforgettable voyage expedition cruising Acheron Passage, Breaksea and Dusky Sounds on the ultimate exploration of Fiordland's iconic Dusky Sound. Bask in the towering fiords, abundant birdlife and rich history in one of New Zealand's best-kept secrets.



## Fiordland Explored

5 Days | From \$4,595 | Feb, Mar, Jul & Sep 2025

Only accessible by sea, Doubtful and Dusky Sounds are among the most isolated areas in New Zealand and home to remote ice-carved mountains, verdant forests and winding fiords rich in wildlife. They are also the locations of some historical firsts and important restoration and conservation projects.



# Set Your Course for Adventure

Japan  
& Asia p8

South Pacific p10

Australia p12

New Zealand & the  
Subantarctic Islands  
p12, 14, 20 & 22

Antarctica p16

## Where in the world can we take you next?

We hope you enjoy planning your next adventure with Heritage Expeditions, for the latest updates, new voyage releases and any promotions please use the QR codes found within the brochure. If you need any help selecting a voyage, our Expedition Specialists are here to help.

We look forward to welcoming you on board our ships for the expedition of a lifetime!

**For reservations or assistance, please contact Heritage Expeditions**

**NZ Freephone: 0800 262 8873**

**[info@heritage-expeditions.com](mailto:info@heritage-expeditions.com)**

Reservation hours: Monday – Friday 8:30am – 5pm NZST



**HERITAGE  
EXPEDITIONS**



Freephone: 0800 262 8873 (NZ) 1800 143 585 (AU) 1866 285 7884 (US/CA)  
Antarctic House, 53B Montreal Street, P.O. Box 7218, Christchurch 8240, New Zealand  
Tel +64 3 365 3500 [info@heritage-expeditions.com](mailto:info@heritage-expeditions.com) [www.heritage-expeditions.com](http://www.heritage-expeditions.com)